

AT A GLANCE

- 2,260 Square Feet Total Living
- 3 bedrooms, bonus/loft room, plus great room
- Quartz kitchen counters, full tile backsplash
- Stainless steel appliances with gas range
- Outdoor fireplace in the covered living area
- Laminate hardwood in entry, kitchen, hallway & great room
- 5-piece master bath with free-standing tub & walk-in closet
- 2-car garage
- Front and rear landscaping
- 10-year home warranty included!

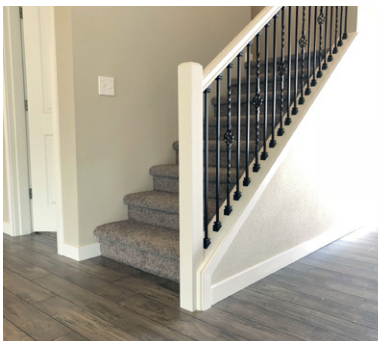

14898 SPARTAN LANE E . SUMNER / MLS# TBD / PRICE: \$439,950



Driving Directions to Sumner Valley Meadows
From Hwy. 410, take the Valley Ave. E exit. Turn South on Valley Avenue to 74th St. Ct. E. Turn Right, follow to the Left on 148th Ave. Ct. E. Community will be on your Left.

FOR SALES INFORMATION



Bill Riley
(253) 686-0654
or briley@govista.net



Jillian Tuatoo Larson
Branch Manager
NMLS ID# 54545
at (253) 686-1127 or
jillian@fairwaymc.com

Lender will contribute up to **\$2,500** toward buyer's closing costs!

LAST UPDATED: April 27, 2018



Photo renderings are for illustrative purposes only. Builder reserves the right to make modifications and changes to prices, floorplans, interior/exterior design, materials and specifications at any time without prior notice and/or obligation.

MAIN LEVEL

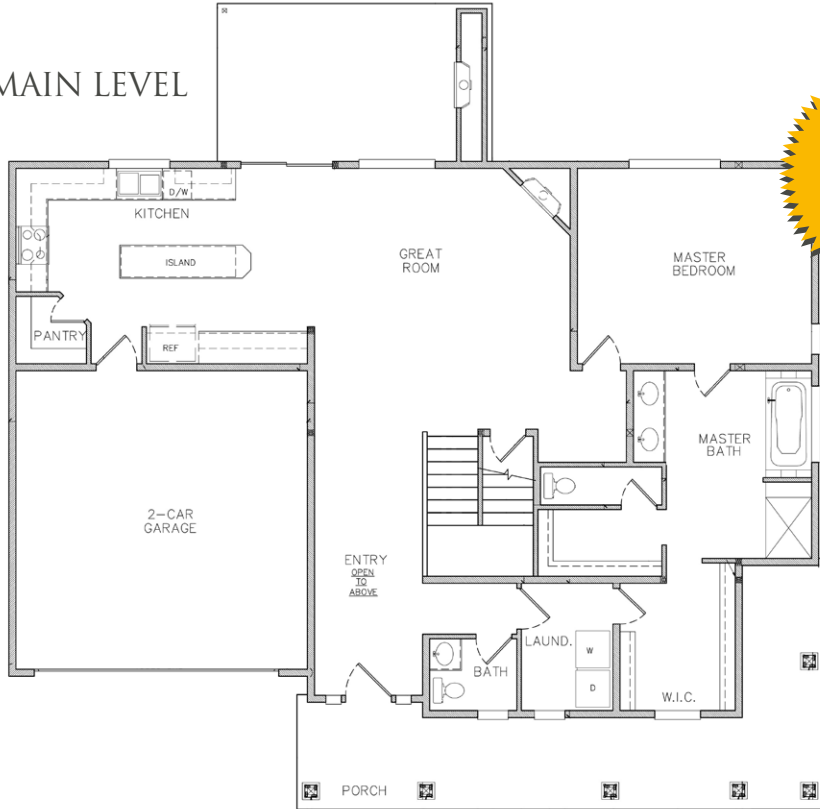

INCLUDES
**Master
Suite**
on Main Level

UPPER LEVEL

